

Aluminium-copper pin terminals BMAN type

FEATURES & BENEFITS

- Cu pin with connection element for Al cables, as per DIN, without galvanic plating
- description of cable cross-section, crimping die number on crimped part surface
- facilitates disconnection after loosening screws in terminal

LOGISTIC DATA

Quantity in package [pcs] 10

MECHANICAL DATA

Material Al-Cu
Surface uncoated

CERTIFICATES & STANDARDS

Design DIN 46329 – concerns diameters the tubular part (Al) apart from BMAN 16 type

NOTE!

- terminals filled with special contact grease, packed in a separate foil bag;
- Sector-shaped conductors must be rounded with special dies.

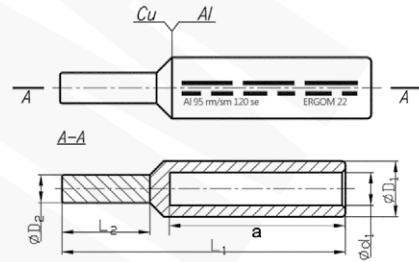

Type	Index Ergom	Cross-section, mm² [mm²]	Cross-section, re/se [mm²]	a	L ₁	L ₂	d ₁	D ₁	D ₂	Socket code no.	Lz/s	Lz/w	Weight [kg]
BMAN 16 (10 PCS)	E13KC-01050100020	16	25	32	65	23	5,5	12,0	6	12	2	4	0,13
BMAN 25 (10 PCS)	E13KC-01050100100	25	35	31	65	23	6,8	12,0	6	12	2	4	0,16
BMAN 35 (10 PCS)	E13KC-01050100200	35	50	43	77	23	8,0	14,0	7	14	3	5	0,25
BMAN 50 (10 PCS)	E13KC-01050100300	50	70		86	32	9,8	16,0	8	16		0,33	
BMAN 70 (10 PCS)	E13KC-01050100400	70	95	53	96	32	11,2	18,5	10	18	3	6	0,54
BMAN 95 (10 PCS)	E13KC-01050100500	95	120	57	108	38	13,2	22,0	12	22	3	6	0,87
BMAN 120 (10 PCS)	E13KC-01050100600	120	150				14,7	23,0					0,9
BMAN 150 (10 PCS)	E13KC-01050100700	150	185	61	112	38	16,3	25,0	12	25	3	7	1,09
BMAN 185 (10 PCS)	E13KC-01050100800	185	240		120	44	18,3	28,5	14	28		1,57	
BMAN 240 (10 PCS)	E13KC-01050100900	240	300	71	132	44	21,0	32,0	16	32	3	7	2,18
BMAN 300 (10 PCS)	E13KC-01050101000	300	-		142	46	23,3	34,0	18	38		2,67	

Lz/s - Number of crimping - wide, Lz/w - Number of crimping - narrow