

Tubular angle terminals, K90D type

FEATURES & BENEFITS

- ring terminal Cu, crimped part as per DIN, with galvanic tin plating and 90 degrees angle terminal fixture
- description of cable cross-section, terminal size and crimping die number on crimped part surface
- for voltage below 1 kV acc. to EN IEC 61238-1-1:2019
for the voltage range 1-36 kV acc. to EN IEC 61238-1-3:2019
-

MECHANICAL DATA

Material	Cu
Surface	tin-plated

CERTIFICATES & STANDARDS

Standards	EN IEC 61238-1-1:2019 EN IEC 61238-1-3:2019 - mechanical strength Class 1 - short-circuit resistance Class A for range of rated cross-section 10 - 240 mm ²
UL certificate	E475284
Design	DIN 46235 – concerns only the tubular part

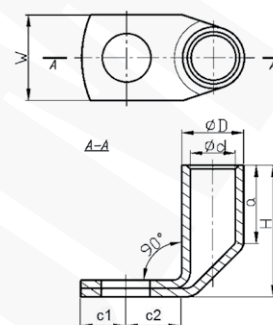

NOTE!

Sector-shaped conductors (sm) must be rounded with special dies.

Type	Index Ergom	Cross-section, mm ²	d	D	a	c1	c2	W	H	Screw hole	UL	Socket code no.	Lz/s	Lz/w	Quantity in package [pcs]	Weight [kg]
K90D 10/5 (100 PCS)	E11KM-02030100100	10	4,5	6,0	10	7,0	10,0	9	14	M5	√	6	-	1	100	0,5
K90D 10/5 (10 PCS)	E11KM-02030100102					10				0,05						
K90D 10/6 (100 PCS)	E11KM-02030100200					100				0,4						
K90D 10/6 (10 PCS)	E11KM-02030100202					10	0,04									
K90D 10/8 (100 PCS)	E11KM-02030100300					100	0,4									
K90D 10/8 (10 PCS)	E11KM-02030100302					10	0,04									
K90D 16/6 (100 PCS)	E11KM-02030100500	16	5,5	8,5	20	7,5	10,0	14	13	M6	√	8	1	2	100	1,3
K90D 16/6 (10 PCS)	E11KM-02030100502					10				0,13						
K90D 16/8 (100 PCS)	E11KM-02030100600					100				1,3						
K90D 16/8 (10 PCS)	E11KM-02030100602					10	0,13									
K90D 16/10 (100 PCS)	E11KM-02030100700					100	1,4									
K90D 16/10 (10 PCS)	E11KM-02030100702					10	0,17									
K90D 16/12 (100 PCS)	E11KM-02030100800	25	7,0	10,0	20	11,0	15,0	17	25	M10	√	10	1	2	100	1,7
K90D 16/12 (10 PCS)	E11KM-02030100802					10				0,17						
K90D 25/6 (100 PCS)	E11KM-02030100900					100				1,7						
K90D 25/6 (10 PCS)	E11KM-02030100902					10	0,17									
K90D 25/8 (100 PCS)	E11KM-02030101000					100	1,7									
K90D 25/8 (10 PCS)	E11KM-02030101002					10	0,17									
K90D 25/10 (100 PCS)	E11KM-02030101100	25	7,0	10,0	20	11,0	15,0	17	26	M10	√	10	1	2	100	2
K90D 25/10 (10 PCS)	E11KM-02030101102					10				0,2						
K90D 25/12 (100 PCS)	E11KM-02030101200					100				1,9						
K90D 25/12 (10 PCS)	E11KM-02030101202					10	0,19									
K90D 25/14 (100 PCS)	E11KM-02030101230					100	2,08									
K90D 25/14 (10 PCS)	E11KM-02030101232					10	0,21									

Type	Index Ergom	Cross-section, rm/sm [mm²]	d	D	a	c1	c2	W	H	Screw hole	UL	Socket code no.	Lz/s	Lz/w	Quantity in package [pcs]	Weight [kg]														
K90D 35/6 (100 PCS)	E11KM-02030101260	35	8,2	12,5	20	7,5	10,0	17		M6	-	12	1	2	100	3,6														
K90D 35/6 (10 PCS)	E11KM-02030101262																					10	0,36							
K90D 35/8 (100 PCS)	E11KM-02030101310					9,0	13,0										M8					100	3,8							
K90D 35/8 (10 PCS)	E11KM-02030101312																									10	0,38			
K90D 35/10 (100 PCS)	E11KM-02030101400					11,0				19	27						M10	√				100	3,8							
K90D 35/10 (10 PCS)	E11KM-02030101402																									10	0,38			
K90D 35/12 (100 PCS)	E11KM-02030101500					12,0											M12					100	3,7							
K90D 35/12 (10 PCS)	E11KM-02030101502																									10	0,37			
K90D 35/14 (100 PCS)	E11KM-02030101530					14,0	18,0										M14	-				100	3,6							
K90D 35/14 (10 PCS)	E11KM-02030101532																									10	0,36			
K90D 50/8 (100 PCS)	E11KM-02030101600					50	10,0	14,5	28	9,0	13,0						M8		14	2	3	100	5							
K90D 50/8 (10 PCS)	E11KM-02030101602																												10	0,5
K90D 50/10 (100 PCS)	E11KM-02030101700									11,0							22							M10	√				100	4,8
K90D 50/10 (10 PCS)	E11KM-02030101702																													
K90D 50/12 (100 PCS)	E11KM-02030101800	12,0								36				M12								100	4,4							
K90D 50/12 (10 PCS)	E11KM-02030101802																									10	0,44			
K90D 50/14 (100 PCS)	E11KM-02030101830	14,0								24				M14	-							100	4,3							
K90D 50/14 (10 PCS)	E11KM-02030101832																									10	0,43			
K90D 50/16 (100 PCS)	E11KM-02030101900	16,0								28				M16	√							100	4,4							
K90D 50/16 (10 PCS)	E11KM-02030101902																									10	0,44			
K90D 70/8 (100 PCS)	E11KM-02030102010	70	11,5	16,5	28					9,0	13,0			M8		16	2	3				100	6,5							
K90D 70/8 (10 PCS)	E11KM-02030102012																												10	0,65
K90D 70/10 (100 PCS)	E11KM-02030102100									11,0				24										M10	√				100	6,7
K90D 70/10 (10 PCS)	E11KM-02030102102																													
K90D 70/12 (100 PCS)	E11KM-02030102200					12,0				37				M12								100	6,4							
K90D 70/12 (10 PCS)	E11KM-02030102202																									10	0,64			
K90D 70/14 (100 PCS)	E11KM-02030102230					14,0								M14	-							100	6,3							
K90D 70/14 (10 PCS)	E11KM-02030102232																									10	0,63			
K90D 70/16 (100 PCS)	E11KM-02030102300					16,0				30				M16	√							100	5,7							
K90D 70/16 (10 PCS)	E11KM-02030102302																									10	0,57			
K90D 95/8 (50 PCS)	E11KM-02030102400					95	13,5	19,0	35	16,0				M8	-				18	2	4	50	5,5							
K90D 95/8 (10 PCS)	E11KM-02030102402																												10	1,1
K90D 95/10 (50 PCS)	E11KM-02030102500									12,0	17,0			28										M10					50	5
K90D 95/10 (10 PCS)	E11KM-02030102502																													
K90D 95/12 (50 PCS)	E11KM-02030102600	18,0								45				M12	√							50	4,85							
K90D 95/12 (10 PCS)	E11KM-02030102602																									10	0,97			
K90D 95/14 (50 PCS)	E11KM-02030102630	20,0												M14	-							50	4,95							
K90D 95/14 (10 PCS)	E11KM-02030102632																									10	0,99			
K90D 95/16 (50 PCS)	E11KM-02030102700	16,0								32				M16								50	4,9							
K90D 95/16 (10 PCS)	E11KM-02030102702																									10	0,98			
K90D 95/20 (50 PCS)	E11KM-02030102800	20,0	24,0											M20	√							50	4,9							
K90D 95/20 (10 PCS)	E11KM-02030102802																									10	0,98			
K90D 120/8 (50 PCS)	E11KM-02030102860	120	15,5	21,0	35					16,0				M8	-	20	2	4				50	6,7							
K90D 120/8 (10 PCS)	E11KM-02030102862																												10	1,34
K90D 120/10 (50 PCS)	E11KM-02030102900					12,0	17,0							M10								50	6,6							
K90D 120/10 (10 PCS)	E11KM-02030102902																									10	1,32			
K90D 120/12 (50 PCS)	E11KM-02030103000					18,0	32			47				M12								50	6,4							
K90D 120/12 (10 PCS)	E11KM-02030103002																									10	1,28			
K90D 120/14 (50 PCS)	E11KM-02030103100					20,0								M14	√							50	6,4							
K90D 120/14 (10 PCS)	E11KM-02030103102																									10	1,28			
K90D 120/16 (50 PCS)	E11KM-02030103200					16,0								M16								50	6,35							
K90D 120/16 (10 PCS)	E11KM-02030103202																									10	1,27			
K90D 120/20 (50 PCS)	E11KM-02030103300					20,0	24,0							M20								50	6,25							
K90D 120/20 (10 PCS)	E11KM-02030103302																									10	1,25			

Type	Index Ergom	Cross-section, rm/sm [mm ²]	d	D	a	c1	c2	W	H	Screw hole	UL	Socket code no.	Lz/s	Lz/w	Quantity in package [pcs]	Weight [kg]						
K90D 150/8 (50 PCS)	E11KM-02030103360	150	17,0	23,5	35	12,0	16,0	34	48	M8	-	22	2	4	50	9,6						
K90D 150/8 (10 PCS)	E11KM-02030103362									10	1,92											
K90D 150/10 (50 PCS)	E11KM-02030103400					17,0	M10	√	50	9,5												
K90D 150/10 (10 PCS)	E11KM-02030103402								10	1,9												
K90D 150/14 (50 PCS)	E11KM-02030103530					16,0	20,0	34	48	M14	-				50	9,4						
K90D 150/14 (10 PCS)	E11KM-02030103532									10	1,88											
K90D 150/12 (50 PCS)	E11KM-02030103500					12,0	18,0	M12	√	50	9,3											
K90D 150/12 (10 PCS)	E11KM-02030103502									10	1,86											
K90D 150/16 (50 PCS)	E11KM-02030103600					16,0	22,0	M16	√	50	9,85											
K90D 150/16 (10 PCS)	E11KM-02030103602									10	1,97											
K90D 150/20 (50 PCS)	E11KM-02030103700					20,0	24,0	38	M20	√	50				9,25							
K90D 150/20 (10 PCS)	E11KM-02030103702										10				1,85							
K90D 185/10 (50 PCS)	E11KM-02030103760					185	19,0	25,5	40	14,0	M10				-	25	2	5	50	10,45		
K90D 185/10 (10 PCS)	E11KM-02030103762																		10	2,09		
K90D 185/12 (50 PCS)	E11KM-02030103800	22,0	37	M12	√					50	10,35											
K90D 185/12 (10 PCS)	E11KM-02030103802									10	2,07											
K90D 185/14 (50 PCS)	E11KM-02030103830	16,0	M14	-	√					50	10,3											
K90D 185/14 (10 PCS)	E11KM-02030103832									10	2,06											
K90D 185/16 (50 PCS)	E11KM-02030103900	20,0	24,0	40	M16					√	50	10,25										
K90D 185/16 (10 PCS)	E11KM-02030103902										10	2,05										
K90D 185/20 (50 PCS)	E11KM-02030104000	20,0	24,0	40	M20					√	50	10,25										
K90D 185/20 (10 PCS)	E11KM-02030104002										10	2,05										
K90D 240/12 (50 PCS)	E11KM-02030104100	240	21,5	29,0	40					14,0	M12	√	28	2	5				50	15,85		
K90D 240/12 (10 PCS)	E11KM-02030104102																		10	3,17		
K90D 240/14 (50 PCS)	E11KM-02030104130									22,0	42	M14							-	√	50	15,9
K90D 240/14 (10 PCS)	E11KM-02030104132																				10	3,18
K90D 240/16 (50 PCS)	E11KM-02030104200					16,0	M16	-	√	50	15,85											
K90D 240/16 (10 PCS)	E11KM-02030104202									10	3,17											
K90D 240/20 (50 PCS)	E11KM-02030104300					20,0	24,0	45	M20	√	50	15,85										
K90D 240/20 (10 PCS)	E11KM-02030104302										10	3,17										
K90D 300/12 (25 PCS)	E11KM-02030104330					300	24,5	32,0	50	14,0	M12	-				32	2	-	25	4,58		
K90D 300/12 (10 PCS)	E11KM-02030104332																		10	11,45		
K90D 300/14 (25 PCS)	E11KM-02030104360									22,0	M14	-							√	25	11,35	
K90D 300/14 (10 PCS)	E11KM-02030104362																			10	4,54	
K90D 300/16 (25 PCS)	E11KM-02030104400									16,0	48	67							M16	-	25	11,25
K90D 300/16 (10 PCS)	E11KM-02030104402																				10	4,5
K90D 300/20 (25 PCS)	E11KM-02030104500	20,0	24,0	M20	-					25	11,43											
K90D 300/20 (10 PCS)	E11KM-02030104502									10	4,58											

Lz/s - Number of crimping - wide, Lz/w - Number of crimping - narrow