

Aluminium-copper longitudinally sealed tubular terminals, KCA type

FEATURES & BENEFITS

- ring terminal Cu-Al, crimped part as per DIN
- description of cable cross-section, terminal size and crimping die number on crimped part surface
- Cu-Al connection within entire terminal cross-section
- recommended for demanding connections

LOGISTIC DATA

Quantity in package [pcs] 10

MECHANICAL DATA

Material Al-Cu
Surface uncoated

CERTIFICATES & STANDARDS

Design DIN 46329 – concerns diameters the tubular part (Al)

NOTE!

- terminals are filled with special contact grease, packed in a separate foil bag;
- sector-shaped conductors must be rounded with special dies.

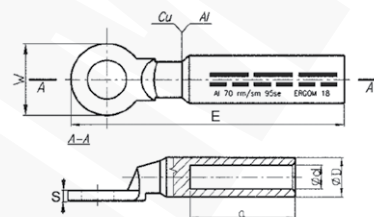

Type	Index Ergom	Cross-section, rm/sm [mm ²]	Cross-section, re/se [mm ²]	a	d	D	E	S	W	Screw hole	Socket code no.	Lz/s	Lz/w	Weight [kg]											
KCA 16/8 (10 PCS)	E13KC-01010100100	16	25	34,0	5,4	12,0	80,0	4,0	24	M8	12	2	4	0,4											
KCA 16/10 (10 PCS)	E13KC-01010100200									M10															
KCA 25/8 (10 PCS)	E13KC-01010100300	25	35	34,0	6,8	12,0	80,0	4,0	24	M8	12	2	4	0,36											
KCA 25/10 (10 PCS)	E13KC-01010100400									M10															
KCA 25/12 (10 PCS)	E13KC-01010100500									M12															
KCA 35/8 (10 PCS)	E13KC-01010100600									M8															
KCA 35/10 (10 PCS)	E13KC-01010100700	35	50	43,0	8,0	14,0	89,0	4,0	24	M10	14	3	5	0,47											
KCA 35/12 (10 PCS)	E13KC-01010100800									M12				0,46											
KCA 35/14 (10 PCS)	E13KC-01010100900									M14				0,42											
KCA 50/8 (10 PCS)	E13KC-01010101000	50	70	43,0	9,8	16,0	89,0	5,0	24	M8	16	3	5	0,4											
KCA 50/10 (10 PCS)	E13KC-01010101100									M10				0,57											
KCA 50/12 (10 PCS)	E13KC-01010101200									M12															
KCA 70/12 (10 PCS)	E13KC-01010101500									70				95	50,5	11,2	18,5	97,0	5,0	24	M12	18	3	6	0,56
KCA 70/14 (10 PCS)	E13KC-01010101600																				M14				
KCA 95/10 (10 PCS)	E13KC-01010101700																				M10				
KCA 95/12 (10 PCS)	E13KC-01010101800	95	120	50,5	13,2	22,0	105,5	5,0	30	M12	22	3	6	0,9											
KCA 95/14 (10 PCS)	E13KC-01010102000									M14															
KCA 95/16 (10 PCS)	E13KC-01010101900									M16															
KCA 120/10 (10 PCS)	E13KC-01010102100	120	150	52,0	14,7	23,0	107,0	6,0	30	M10	22	3	7	1,1											
KCA 120/16 (10 PCS)	E13KC-01010102300									M16															
KCA 150/12 (10 PCS)	E13KC-01010102600	150	185	62,0	16,3	25,0	119,0	6,0	30	M12	25	3	7	1,2											
KCA 185/20 (10 PCS)	E13KC-01010103400	185	240	62,0	18,3	28,5	122,0	6,5	35	M20	28	3	7	2,2											
KCA 240/16 (10 PCS)	E13KC-01010103700	240	300	72,0	21,0	32,0	136,0	6,5	35	M16	32	3	8	3,4											
KCA 300/10 (10 PCS)	E13KC-01010104000	300	-	72,0	23,3	34,0	142,0	7,0	36	M10	34	3	8	3,5											
KCA 300/12 (10 PCS)	E13KC-01010104100									M12				3,63											
KCA 300/14 (10 PCS)	E13KC-01010104300									M14															
KCA 300/16 (10 PCS)	E13KC-01010104200									M16				3,55											

Lz/s - Number of crimping - wide, Lz/w - Number of crimping - narrow

Date of publication: 15/12/2023

Graphic project, pictures and all technical data and descriptions in this catalogue are protected by Polish and international copyright laws. Names and logos used in the content of this catalogue may be trademarks, for which ZAE Ergom Sp. z o.o. has exclusive protection rights. ZAE ERGOM reserves the right for changes in the assortment and parameters of its products.