

# Tubular terminals for 2 bolts KDM ... 2X type

## FEATURES & BENEFITS

- two-ring terminal Cu, crimped part as per DIN, without galvanic tin plating
- description of cable cross-section, terminal size and crimping die number on crimped part surface
- other designs on client's request

## LOGISTIC DATA

Quantity in package [pcs] 1

## MECHANICAL DATA

Material Cu  
Surface uncoated

## CERTIFICATES & STANDARDS

Design DIN 46235 – concerns only the tubular part

## NOTE!

Sector-shaped conductors (sm) must be rounded with special dies.

Other sizes on request.

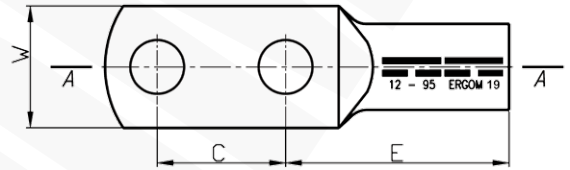

A-A

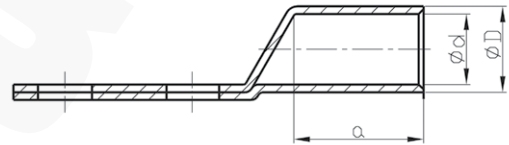

Type	Index Ergom	Cross-section, rm/sm [mm <sup>2</sup> ]	d	D	a	C	E	W	Screw hole	Socket code no.	Lz/s	Lz/w	Weight [kg]
KDM 10/2x6	E11KM-02010200100	10	4,5	6,0	12	30	27	9,0	M6	6	-	1	0,05
KDM 16/2x8	E11KM-02010200200	16	5,5	8,5	20	30	36	13,0	M8	8	1	2	0,05
KDM 25/2x10	E11KM-02010200300	25	7,0	10,0	20	30	38	17,0	M10	10	1	2	0,06
KDM 35/2x10	E11KM-02010200400	35	8,2	12,5	20	30	42	19,0	M10	12	1	2	0,06
KDM 50/2x10	E11KM-02010200500	50	10,0	14,5	28	30	52	20,0	M10	14	2	3	0,07
KDM 50/2x12	E11KM-02010200600								M12				
KDM 70/2x10	E11KM-02010200700	70	11,5	16,5	28	40	55	24,0	M10	16	2	3	0,09
KDM 70/2x12	E11KM-02010200800								M12				
KDM 95/2x12	E11KM-02010200900	95	13,5	19,0	35	40	65	28,0	M12	18	2	4	0,15
KDM 120/2x12	E11KM-02010201000	120	15,5	21,0	35	40	70	32,0	M12	20	2	4	0,17
KDM 150/2x12	E11KM-02010201100	150	17,0	23,5	40	40	78	34,0	M12	22	2	4	0,26
KDM 185/2x12	E11KM-02010201200	185	19,0	25,5	42	40	82	37,0	M12	25	2	5	0,29
KDM 240/2x16	E11KM-02010201300	240	21,5	29,0	42	40	92	42,0	M16	28	2	5	0,39
KDM 300/2x16	E11KM-02010201400	300	24,5	32,0	50	40	104	45,0	M16	32	2	-	0,54
KDM 400/2x16	E11KM-02010201500	400	22,5	38,5	70	40	115	55,0	M16	38	3	-	0,92
KDM 400/2x16-50	E11KM-02010201600		27,5										50

Date of publication: 15/12/2023

Graphic project, pictures and all technical data and descriptions in this catalogue are protected by Polish and international copyright laws. Names and logos used in the content of this catalogue may be trademarks, for which ZAE Ergom Sp. z o.o. has exclusive protection rights. ZAE ERGOM reserves the right for changes in the assortment and parameters of its products.

Type	Index Ergom	Cross-section, mm <sup>2</sup> [mm <sup>2</sup> ]	d	D	a	C	E	W	Screw hole	Socket code no.	Lz/s	Lz/w	Weight [kg]
<b>KDM 500/2x16</b>	E11KM-02010201700	500	31,0	42,0	70	40	125	60,0	M16	42	3	-	1,1
<b>KDM 500/2x16-50</b>	E11KM-02010201800					50							1,29
<b>KDM 625/2x16</b>	E11KM-02010201900	625	34,5	44,0	80	40	135	60,0	M16	44	3	-	1,02

Lz/s - Number of crimping - wide, Lz/w - Number of crimping - narrow

