

Tubular terminals for 2 bolts KDR ... 2X type

FEATURES & BENEFITS

- two-ring terminal Cu, crimped part as per DIN, with galvanic tin plating
- description of cable cross-section, terminal size and crimping die number on crimped part surface
- other designs on client's request

LOGISTIC DATA

Quantity in package [pcs] 1

MECHANICAL DATA

Material Cu
Surface tin-plated

CERTIFICATES & STANDARDS

Design DIN 46235 – concerns only the tubular part

NOTE!

Sector-shaped conductors (sm) must be rounded with special dies.

Other sizes on request.

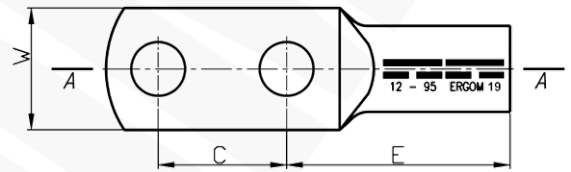

A-A

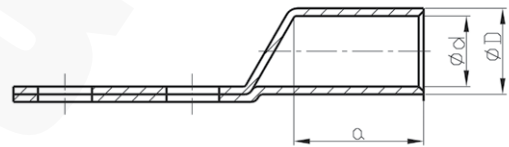

Type	Index Ergom	Cross-section, mm ²	d	D	a	C	E	W	Screw hole	Socket code no.	Lz/s	Lz/w	Weight [kg]
KDR 10/2x6	E11KM-02020200100	10	4,5	6,0	12	30	27	9,0	M6	6	-	1	0,05
KDR 16/2x8	E11KM-02020200200	16	5,5	8,5	20	30	36	13,0	M8	8	1	2	0,05
KDR 25/2x10	E11KM-02020200300	25	7,0	10,0	20	30	38	17,0	M10	10	1	2	0,06
KDR 35/2x10	E11KM-02020200400	35	8,2	12,5	20	30	42	19,0	M10	12	1	2	0,06
KDR 50/2x10	E11KM-02020200500	50	10,0	14,5	28	30	52	20,0	M10	14	2	3	0,07
KDR 50/2x12	E11KM-02020200601								M12				
KDR 70/2x10	E11KM-02020200700	70	11,5	16,5	28	40	55	24,0	M10	16	2	3	0,09
KDR 70/2x12	E11KM-02020200800								M12				
KDR 95/2x12	E11KM-02020200900	95	13,5	19,0	35	40	65	28,0	M12	18	2	4	0,15
KDR 120/2x12	E11KM-02020201000	120	15,5	21,0	35	40	70	32,0	M12	20	2	4	0,17
KDR 150/2x12	E11KM-02020201100	150	17,0	23,5	40	40	78	34,0	M12	22	2	4	0,26
KDR 185/2x12	E11KM-02020201200	185	19,0	25,5	42	40	82	37,0	M12	25	2	5	0,29
KDR 240/2x16	E11KM-02020201300	240	21,5	29,0	42	40	92	42,0	M16	28	2	5	0,39
KDR 300/2x16	E11KM-02020201400	300	24,5	32,0	50	40	104	45,0	M16	32	2	-	0,54
KDR 400/2x16	E11KM-02020201600	400	27,5	38,5	70	40	115	55,0	M16	38	3	-	0,92
KDR 400/2x16-50	E11KM-02020201610												

Date of publication: 15/12/2023

Graphic project, pictures and all technical data and descriptions in this catalogue are protected by Polish and international copyright laws. Names and logos used in the content of this catalogue may be trademarks, for which ZAE Ergom Sp. z o.o. has exclusive protection rights. ZAE ERGOM reserves the right for changes in the assortment and parameters of its products.

Type	Index Ergom	Cross-section, mm ² [mm ²]	d	D	a	C	E	W	Screw hole	Socket code no.	Lz/s	Lz/w	Weight [kg]
KDR 500/2x16	E11KM-02020201700	500	31,0	42,0	70	40	125	60,0	M16	42	3	-	1,1
KDR 500/2x16-50	E11KM-02020201801					50							1,29
KDR 625/2x16	E11KM-02020201900	625	34,5	44,0	80	40	135	60,0	M16	44	3	-	1,02

Lz/s - Number of crimping - wide, Lz/w - Number of crimping - narrow

