

# Insulated spade terminals, KWI...PCV

## FEATURES & BENEFITS

- spade terminal Cu, with polyamide insulating sleeve, marked with screw size and cable cross-section
- to operate in narrower temperature ranges than terminals with polyamide insulation
- insulating sleeve: enhances resistance to vibrations, mitigates short-circuit risk
- sleeve colours facilitate cross-section identification



## LOGISTIC DATA

Quantity in package [pcs] 100

## MECHANICAL DATA

Insulation polyvinyl chloride (PCV)  
 Material Cu  
 Surface tin-plated  
 Operating temperature [°C] -5 ÷ +60

## CERTIFICATES & STANDARDS

Design DIN 46237 – concerns only the tubular part

## NOTE!

Non-soldered design in PVC insulation, on demand.

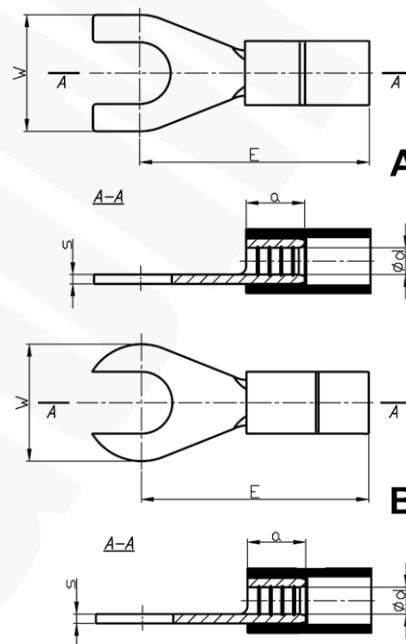

| Type                      | Index Ergom       | Cross-section [mm <sup>2</sup> ] | Insulation colour | Screw hole | Design | DIN | d   | s   | a | E    | W   | Weight [kg] |
|---------------------------|-------------------|----------------------------------|-------------------|------------|--------|-----|-----|-----|---|------|-----|-------------|
| KWI 1/2,5 PCV (100 PCS)   | E09KO-02030400100 | 0,5+1                            | red               | M2,5       | A      | √   | 1,6 | 0,8 | 5 | 16,0 | 6,0 | 0,08        |
| KWI 1/3 PCV (100 PCS)     | E09KO-02030400200 |                                  |                   | M3         |        |     |     |     |   |      |     | 0,07        |
| KWI 1/3,5 PCV (100 PCS)   | E09KO-02030400300 |                                  |                   | M3,5       |        |     |     |     |   |      |     | 0,08        |
| KWI 1/4 PCV (100 PCS)     | E09KO-02030400400 |                                  |                   | M4         |        |     |     |     |   |      |     | 8,0         |
| KWI 1/4 W PCV (100 PCS)   | E09KO-02030200300 |                                  |                   | M4         |        |     |     |     |   |      |     | 6,9         |
| KWI 1/5 PCV (100 PCS)     | E09KO-02030400500 |                                  |                   | M5         |        |     |     |     |   |      |     | 17,0        |
| KWI 1/6 PCV (100 PCS)     | E09KO-02030400600 |                                  |                   | M6         |        |     |     |     |   |      |     | 18,0        |
| KWI 1/6 PCV (100 PCS)     | E09KO-02030400600 |                                  |                   | M6         |        |     |     |     |   |      |     | 10,0        |
| KWI 1/8 PCV (100 PCS)     | E09KO-02030400700 |                                  |                   | M8         |        |     |     |     |   |      |     | 19,2        |
| KWI 1/8 PCV (100 PCS)     | E09KO-02030400700 |                                  |                   | M8         |        |     |     |     |   |      |     | 14,0        |
| KWI 2,5/3 PCV (100 PCS)   | E09KO-02030400900 | 1,5+2,5                          | blue              | M3         | A      | √   | 2,3 | 0,8 | 5 | 17,0 | 6,0 | 0,09        |
| KWI 2,5/3,5 PCV (100 PCS) | E09KO-02030401000 |                                  |                   | M3,5       |        |     |     |     |   |      |     | 0,08        |
| KWI 2,5/4 PCV (100 PCS)   | E09KO-02030401100 |                                  |                   | M4         |        |     |     |     |   |      |     | 8,0         |
| KWI 2,5/4 W PCV (100 PCS) | E09KO-02030200600 |                                  |                   | M4         |        |     |     |     |   |      |     | 6,9         |
| KWI 2,5/5 PCV (100 PCS)   | E09KO-02030401200 |                                  |                   | M5         |        |     |     |     |   |      |     | 20,0        |
| KWI 2,5/6 PCV (100 PCS)   | E09KO-02030401300 |                                  |                   | M6         |        |     |     |     |   |      |     | 22,0        |
| KWI 2,5/8 PCV (100 PCS)   | E09KO-02030401400 |                                  |                   | M8         |        |     |     |     |   |      |     | 20,2        |
| KWI 2,5/10 PCV (100 PCS)  | E09KO-02030401500 |                                  |                   | M10        |        |     |     |     |   |      |     | 23,3        |
| KWI 2,5/10 PCV (100 PCS)  | E09KO-02030401500 |                                  |                   | M10        |        |     |     |     |   |      |     | 17,5        |
| KWI 2,5/12 PCV (100 PCS)  | E09KO-02030401600 |                                  |                   | M12        |        |     |     |     |   |      |     | 25,7        |
| KWI 2,5/12 PCV (100 PCS)  | E09KO-02030401600 | M12                              | 20,0              |            |        |     |     |     |   |      |     |             |

| Type                           | Index Ergom       | Cross-section [mm <sup>2</sup> ] | Insulation colour | Screw hole | Design | DIN | d   | s   | a | E    | W    | Weight [kg] |
|--------------------------------|-------------------|----------------------------------|-------------------|------------|--------|-----|-----|-----|---|------|------|-------------|
| <b>KWI 6/3,5 PCV (100 PCS)</b> | E09KO-02030401700 | 4÷6                              | yellow            | M3,5       | A      | √   | 3,6 | 1,0 | 6 | 20,0 | 8,0  | 0,17        |
| <b>KWI 6/4 PCV (100 PCS)</b>   | E09KO-02030401800 |                                  |                   | M4         |        |     |     |     |   |      |      |             |
| <b>KWI 6/5 PCV (100 PCS)</b>   | E09KO-02030401900 |                                  |                   | M5         |        |     |     |     |   | 21,0 | 10,0 | 0,18        |
| <b>KWI 6/6 PCV (100 PCS)</b>   | E09KO-02030402000 |                                  |                   | M6         |        |     |     |     |   |      |      |             |
| <b>KWI 6/8 PCV (100 PCS)</b>   | E09KO-02030402100 |                                  |                   | M8         |        |     |     |     |   | 25,0 | 14,0 | 0,22        |
| <b>KWI 6/10 PCV (100 PCS)</b>  | E09KO-02030402200 |                                  |                   | M10        | B      |     |     |     |   | 27,0 | 18,0 | 0,29        |