





# Insulated “butt splice” connectors, KLI...PCV type

## FEATURES & BENEFITS

-  connector Cu, with polyamide insulation, to make “butt splice” cable connections
-  to operate in narrower temperature ranges than terminals with polyamide insulation
-  insulating sleeve: enhances resistance to vibrations, mitigates short-circuit risk
-  sleeve colours facilitate cross-section identification

## LOGISTIC DATA

Quantity in package [pcs]	100
---------------------------	-----

## MECHANICAL DATA

Insulation	polyvinyl chloride
Material	Cu
Surface	tin-plated
Operating temperature [°C]	-5 ÷ +60

## DIMENSIONS

$L_2$	15
-------	----

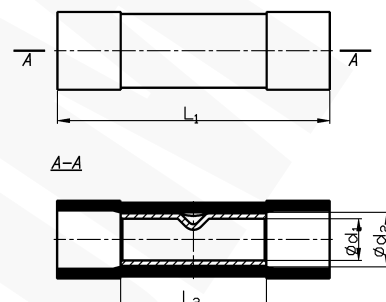

Type	Index Ergom	Cross-section [mm²]	Insulation colour	$L_1$	$d_1$	$d_2$	Weight [kg]
KLI 1 PCV (100 PCS)	E09KO-02060300101	0,75÷1,0	red	25	1,7	4,3	0,11
KLI 2,5 PCV (100 PCS)	E09KO-02060300201	1,5÷2,5	blue	26,5	2,4	4,8	0,14
KLI 6 PCV (100 PCS)	E09KO-02060300301	4÷6	yellow	26,5	3,6	6,5	0,23