

Compression connectors with barrier, LAWP ... type

FEATURES & BENEFITS

- ☒ tight connector Al, crimped part as per DIN, without galvanic tin plating, not mechanically loaded
- ☒ description of cable cross-section, crimping die number on crimped part surface
- ☒ for operation with MV equipment; connector shape ensures more even electromagnetic field distribution
- ☒ cable cross-section change impossible

LOGISTIC DATA

Quantity in package [pcs] 10

MECHANICAL DATA

Material Al
Surface uncoated

ELECTRICAL DATA

Voltage [kV] 1 ÷ 36

CERTIFICATES & STANDARDS

Design DIN 46267 Part 2 – concerns diameters the tubular part

NOTE!

- terminals are filled with special contact grease, packed in a separate foil bag;
- sector-shaped conductors must be rounded with special dies.

Tin version on request

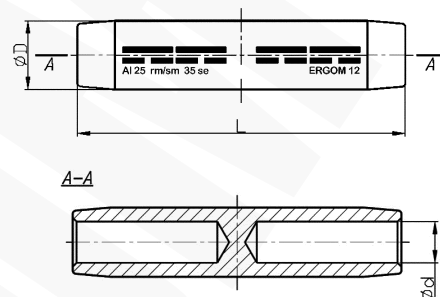

Type	Index Ergom	Cross-section, re/se [mm²]	Cross-section, rm/sm [mm²]	d	D	L	Socket code no.	Lz/s	Lz/w	Weight [kg]
LAWP 16 (10 PCS)	E12KA-01120300102	25	16	5,6	12	85	12	2-2	4-4	0,2
LAWP 25 (10 PCS)	E12KA-01120300202	35	25	6,8	12,0	85	12	2-2	4-4	0,2
LAWP 35 (10 PCS)	E12KA-01120300302	50	35	8,0	14,0	100	14	2-2	5-5	0,3
LAWP 50 (10 PCS)	E12KA-01120300402	70	50	9,8	16,0	100	16	2-2	5-5	0,35
LAWP 70 (10 PCS)	E12KA-01120300502	95	70	11,2	18,5	120	18	3-3	6-6	0,56
LAWP 95 (10 PCS)	E12KA-01120300602	120	95	13,2	22,0	136	22	3-3	6-6	0,9
LAWP 120 (10 PCS)	E12KA-01120300702	150	120	14,7	23,0	136	22	3-3	6-6	0,8
LAWP 150 (10 PCS)	E12KA-01120300802	185	150	16,3	25,0	150	25	3-3	6-6	1,1
LAWP 185 (10 PCS)	E12KA-01120300902	240	185	18,3	28,5	150	28	3-3	6-6	1,5
LAWP 240 (10 PCS)	E12KA-01120301002	300	240	21,0	32,0	170	32	3-3	8-8	2,1

Lz/s - Number of crimping - wide, Lz/w - Number of crimping - narrow