

# Cable connectors, KT type

## FEATURES & BENEFITS

T-shaped connector Cu, standard, with galvanic tin plating

not mechanically loaded

## LOGISTIC DATA

Quantity in package [pcs] 1

## MECHANICAL DATA

Material Cu

Surface tin-plated

## CERTIFICATES & STANDARDS

Design standard

## NOTE!

Sector-shaped conductors (sm) must be rounded with special dies.

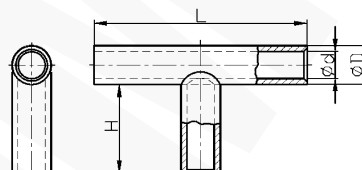

Type	Index Ergom	Cross-section, rm/ sm [mm <sup>2</sup> ]	d	D	L	H	Socket code no.	Lz/s	Lz/w	Weight [kg]
KT 10	E11KM-01080100202	10	4,5	7,0	35	14	7	1	1	0,02
KT 16	E11KM-01080100302	16	5,5	8,5	50	21	8	1	1	0,03
KT 25	E11KM-01080100402	25	7,0	10,0	55	23	10	1	2	0,03
KT 35	E11KM-01080100502	35	8,5	12,0	70	30	12	1	2	0,06
KT 50	E11KM-01080100602	50	10,0	14,0	80	34	14	1	3	0,08
KT 70	E11KM-01080100702	70	12,0	16,5	85	35	16	1	3	0,11
KT 95	E11KM-01080100802	95	13,5	18,0	90	36	17	2	4	0,12
KT 120	E11KM-01080100902	120	15,0	19,5	95	38	19	2	4	0,15
KT 150	E11KM-01080101002	150	16,5	21,0	110	44	20	2	4	0,18
KT 185	E11KM-01080101102	185	19,0	24,0	115	45	23	2	4	0,24
KT 240	E11KM-01080101202	240	21,0	26,0	130	52	25	2	4	0,32
KT 300	E11KM-01080101312	300	24,0	30,0	155	62	28	2	6	0,37
KT 400	E11KM-01080101412	400	27,5	33,5	180	72	32	2	-	0,44

Lz/s - Number of crimping - wide, Lz/w - Number of crimping - narrow