

# Male push on connectors, WR type

## FEATURES & BENEFITS

male push-on connector with galvanic tin plating, for manual installation

rounded shape of crimped part facilitates cable installation

## LOGISTIC DATA

Quantity in package [pcs] 100

## MECHANICAL DATA

Material brass  
Surface tin-plated  
Size 6,3 x 0,8

## DIMENSIONS

s 0,38  
L<sub>1</sub> 20,0  
L<sub>2</sub> 8,0  
a<sub>1</sub> 8,5  
a<sub>2</sub> 5,0

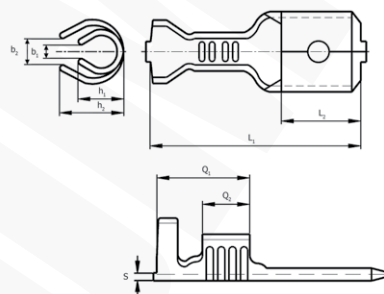

**EAC**

Type	Index Ergom	Cross-section [mm <sup>2</sup> ]	b <sub>1</sub>	b <sub>2</sub>	h <sub>1</sub>	h <sub>2</sub>	Weight [kg]
WR 6,3-1/0,8 (100 PCS)	E10KN-01020300101	0,5+1	1,5	2,3	2,7	4,0	0,06
WR 6,3-2,5/0,8 (100 PCS)	E10KN-01020300201	1,5+2,5	1,4	2,8	3,2	4,5	0,06
WR 6,3-6/0,8 (100 PCS)	E10KN-01020300301	4+6	3,2	3,3	5,2	6,5	0,07