

LV support insulators, IWS type

FEATURES & BENEFITS

- full type examination
- body made of polyester reinforced with glass fibres
- short-circuit strength, as per EN61439-1, confirmed by test results

LOGISTIC DATA

Quantity in package [pcs] 10

APPLICATION

Mounting busbar supports in switchboards and control boards.

MECHANICAL DATA

Material body – polyester resin; threaded rods – stainless steel

Strength [daN] (tension) 222

Strength [daN] (flexion) 166

ELECTRICAL DATA

Test voltage [kV] 5

Rated voltage [V AC] 1000

CERTIFICATES & STANDARDS

Standards insulators were tested according to EN -91062-1, RoHS

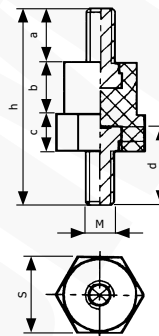

Type	Index Ergom	a	b	c	d	h	M	s	Max. recommended tightening torque [Nm]	Screw	Recommended maximum bus width [mm]	Weight [g]
IWS-14/M6 (10 PCS)	R32RZ-06010200103	12	7	7	16,7	38	6	13,8	3	6	14	110
IWS-24/M8 (10 PCS)	R32RZ-06010200203	14,5	14	9,8	21,3	52,8	8	19,4	6	8	20	300