

# Copper earthing connections, PU type

## FEATURES & BENEFITS

- ☒ copper braided lines
- ☒ high mechanical strength and flexibility
- ☒ for protective and/or equipotential connections
- ☒ other sizes available on request

## MECHANICAL DATA

**Material** tin plated copper braided line with tin plated copper terminals

## NOTE!

On request, we make stranded copper earthing connections according to drawings.

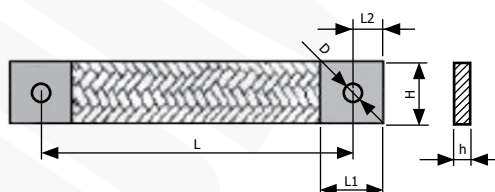
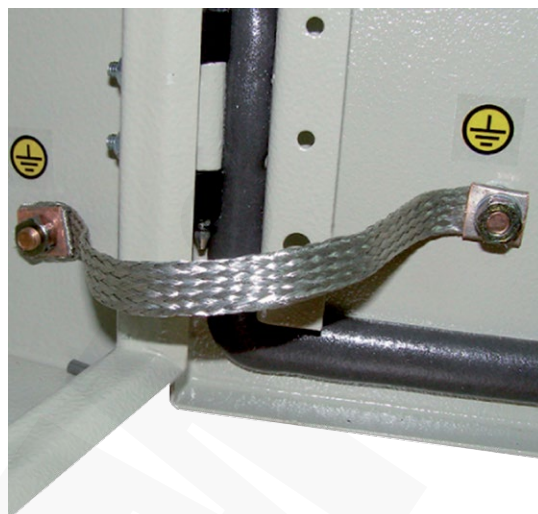

Type	Index Ergom	Cross-section [mm <sup>2</sup> ]	H	D	h	L	L1	L2
PU620/6	R30RS-04050000101	6	16	6,5	2	200	17	5,6
PU1017/6	R30RS-04050000151	10	16	6,5	2	170	17	5,6
PU1620/8	R30RS-04050000301	16	19	8,5	3	200	19	10
PU2520/8	R30RS-04050000401	25	20	8,5	3,5	200	20	10
PU3520/8	R30RS-04050000501	35	20	8,5	4	200	20	10
PU5020/8	R30RS-04050000601	50	28	8,5	4,5	200	28	14