

# Pre-punched busbars, PMG type

## FEATURES & BENEFITS



busbars made of ECU-58 type electrochemical copper



busbars dedicated to LV systems



in non-tin-plated and tin-plated version

## LOGISTIC DATA

Quantity in package [m]

2

## APPLICATION

Energy distribution in LV switchboards and electrical cabinets.

## MECHANICAL DATA

Material

copper M1E (ECU-58)

## NOTE!

On request, we can provide tin plated busbars.

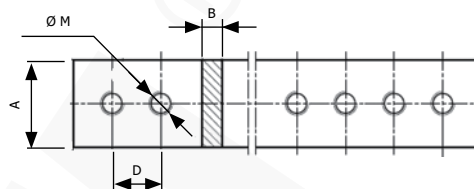
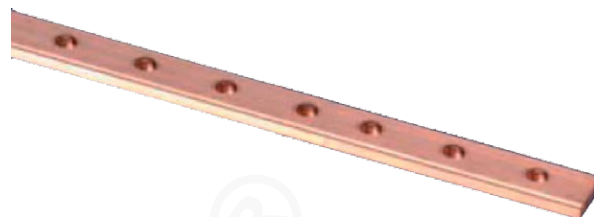

Type	Index Ergom	A	B	D	Ø M	Cross-section [mm <sup>2</sup> ]	Weight [kg]
PMG 12X4/2	R32RZ-01020000101	12	4	18	M5	48	0,4
PMG 15X4/2	R32RZ-01020000201	15	4	20	M6	75	0,5
PMG 20X5/2	R32RZ-01020000601	20	5	20	M6	100	1,71
PMG 25X5/2	R32RZ-01020000701	25	5	20	M6	125	2,15
PMG 30X5/2	R32RZ-01020000801	30	5	25	M6	150	2,6
PMG 50X5/2	R32RZ-01020000901	50	5	25	M8	250	3,84