





FEATURES & BENEFITS

-  fan for switchgear climate control
-  mounting in 92x92 hole
-  capacity 20 m³/h
-  high motor durability resulting from bearings used

LOGISTIC DATA

Type	WRF 20/230
Index Ergom	R37RC-02010100101
Weight [kg]	0,41

Fans are equipped with a 230 V, 50/60 Hz AC motor. Ball bearings increase the reliability and operating time. Fans are offered in housings for direct mounting in electric cabinet walls. As a standard, enclosures are fitted with air filters. These filters are also offered as separate articles.

APPLICATION

Switchgear and electrical cabinets. Application of fans facilitates discharge of heat emitted in systems installed in electrical cabinets, makes dust and water condensate impossible to settle inside electrical cabinets.

MECHANICAL DATA

Colour	RAL 7035
Housing material	filter: self-extinguishing plastic in grey colour fan: aluminium alloy, plastic
Filter cartridge material	self-extinguishing, nylon unwoven fabric
Fan blade material	plastic
Bearings	ball bearing
Noise level [dB]	41
Motor type	AC inductive
Operating temperature [°C]	-10 ÷ +55
Efficiency [m³/h]	20
Efficiency with filter [m³/h]	15
Efficiency, free flow [m³/h]	20

ELECTRICAL DATA

Rated power [W]	16
Rated voltage [V AC]	230, 50 Hz
Rated current [A AC]	0,08

CERTIFICATES & STANDARDS

IP degree of protection	IP43, according to IEC 60529
Standards	EN 55014-1:2004; EN 55014-2:1999 – AC and DC fans. EN 60335-2-80:2007; EN 60335-1:2004+EN 60335-1:2004/A1:2005, EN 60335-1:2004/A2:2006 – AC fans.

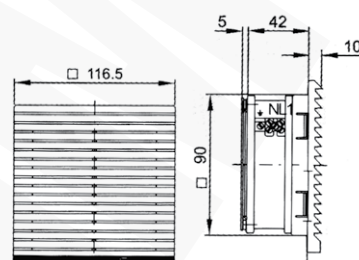

Fan with filter

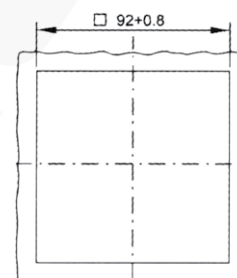

Installing section



NOTE!

To punch holes for fans we offer blanking dies e.g. SQ92 or SY92.

