





FEATURES & BENEFITS

-  fan for switchgear climate control
-  mounting in 92x92 hole
-  capacity 20 m³/h
-  high motor durability resulting from bearings used

LOGISTIC DATA

| | |
|-------------|-------------------|
| Type | WRF 20/24 |
| Index Ergom | R37RC-02010100201 |
| Weight [kg] | 0,21 |

Fans are equipped with a 24 V DC motor. Ball bearings increase the reliability and operating time. Fans are offered in housings for direct mounting in electric cabinet walls. As a standard, enclosures are fitted with air filters. These filters are also offered as separate articles.

APPLICATION

Switchgear and electrical cabinets. Application of fans facilitates discharge of heat emitted in systems installed in electrical cabinets, makes dust and water condensate impossible to settle inside electrical cabinets.

MECHANICAL DATA

| | |
|-------------------------------|--|
| Colour | RAL 7035 |
| Housing material | filter: self-extinguishing plastic in grey colour fan: aluminium alloy, plastic |
| Filter cartridge material | self-extinguishing, nylon unwoven fabric |
| Fan blade material | plastic |
| Noise level [dB] | 41 |
| Motor type | brushless direct current motor |
| Operating temperature [°C] | -10 ÷ +55 |
| Efficiency [m³/h] | 20 |
| Efficiency with filter [m³/h] | 15 |
| Efficiency, free flow [m³/h] | 20 |

ELECTRICAL DATA

| | |
|----------------------|------|
| Rated power [W] | 4,3 |
| Rated voltage [V DC] | 24 |
| Rated current [A DC] | 0,18 |

CERTIFICATES & STANDARDS

| | |
|-------------------------|--|
| IP degree of protection | IP43, according to IEC 60529 |
| Standards | EN 55014-1:2004; EN 55014-2:1999 – AC and DC fans. EN 60335-2-80:2007; EN 60335-1:2004+EN 60335-1:2004/A1:2005, EN 60335-1:2004/A2:2006 – AC fans. |

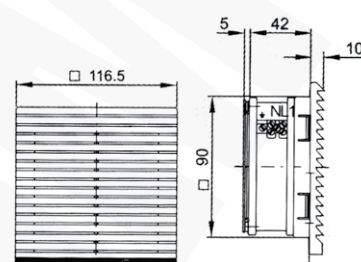

Fan with filter

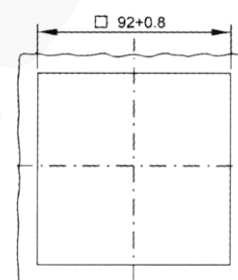

Installing section



NOTE!

To punch holes for fans we offer blanking dies e.g. SQ92 or SY92.

